

Model 1200, 1240, 1242, 1242E, 1244, 1244E

PowerLuber Grease Gun

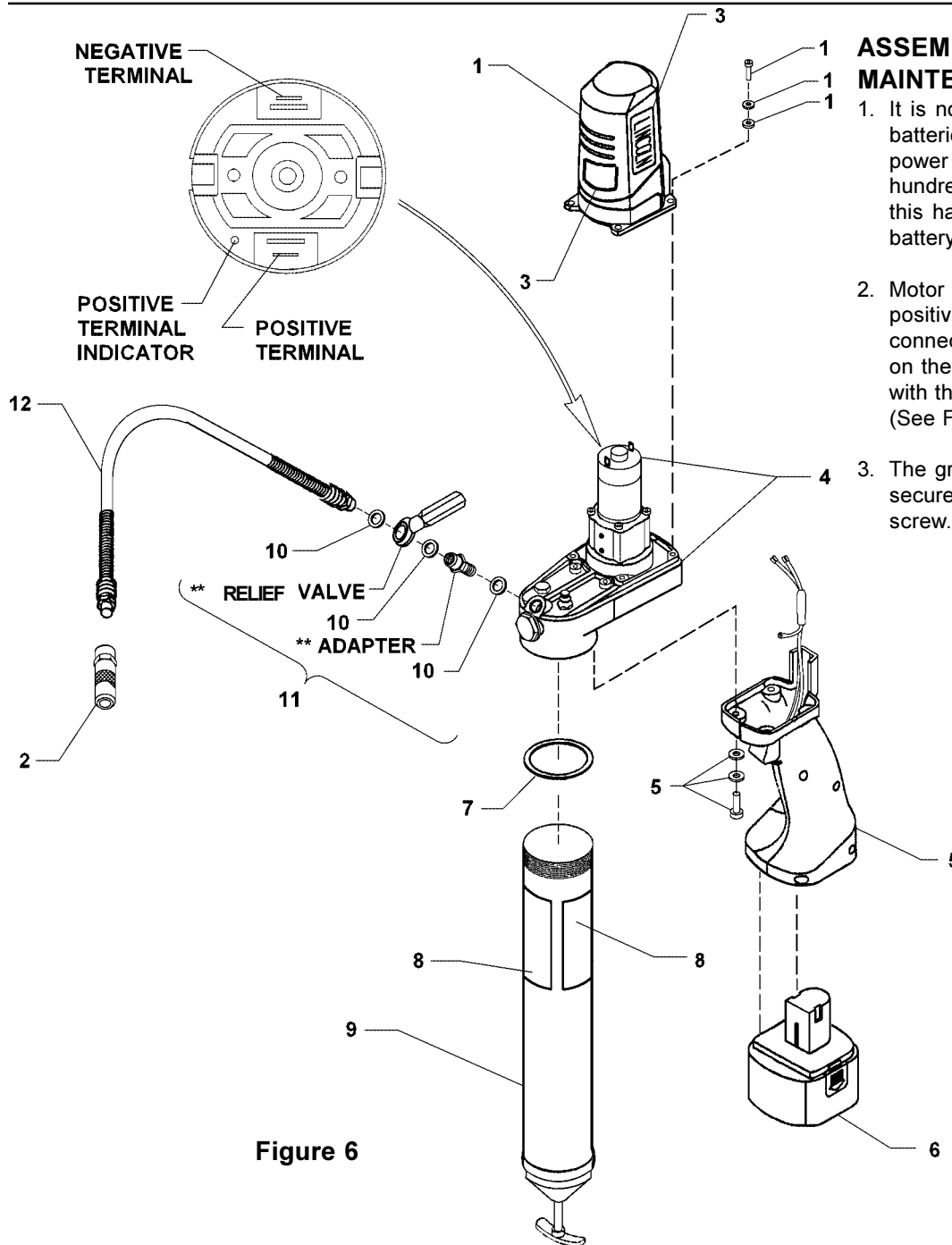

ASSEMBLY AND MAINTENANCE NOTES:

1. It is normal for nickel-cadmium batteries to gradually lose their power retention capacity over hundreds of charge cycles. When this happens replacement of the battery pack will be required.
2. Motor polarity is important, the positive, (red) wire must be connected to the positive terminal on the motor, which is identified with the small plastic dot next to it. (See Fig.6)
3. The green ground wire must be secured under the motor mounting screw.

Figure 6

SERVICE PARTS

Item	Description	Part No.	Item	Description	Part No.
1	Motor housing	271876	7	Packing	271880
2	Coupler	5852	8	Caution label kit	271881
3	Nameplate	271877	9	Grease tube assembly	271882
4	Pump assembly	271878	10	Gasket kit	271884
5	Handle assembly	271879	11	Pressure relief kit	271883
6	Battery	1201	12	Flexible hose 30"	1230

** Sold only in Kit (Item 11) along with gaskets (Item 10)

LINCOLN



-

SERVICE PARTS (Con't)

Form 403155